

1
Install Cyldro fixture first.
 Do not install BMR16 spotlight until the Cyldro fixture is hanging in its final position.

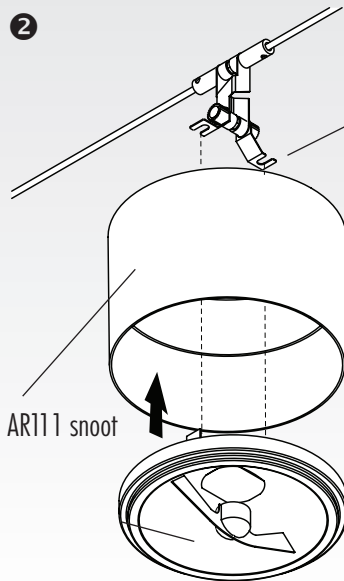

2
 Unpack BAR111 with two hex wrenches, and AR111 snoot. Insert lamp into bottom of snoot and hold in place with lamp contacts in lamp holder.
 50W max MR16 lamp (not supplied)

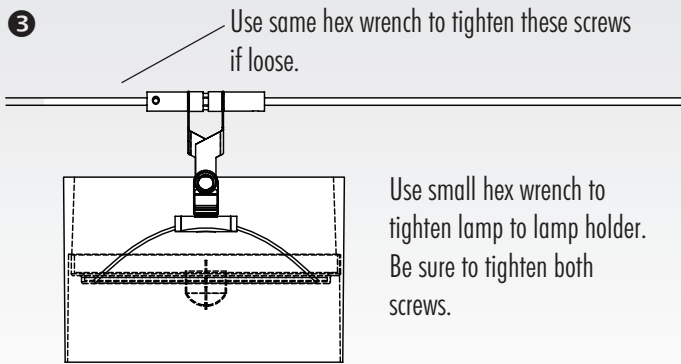

3
 Use same hex wrench to tighten these screws if loose.
 Use small hex wrench to tighten lamp to lamp holder. Be sure to tighten both screws.

WARNING: RISK of ELECTRIC SHOCK

Do not install in fixture with power on. Never allow suspension cables to touch BAR111 contact rods or rod holder. Do not use AR111 lamp of more than 50 watts. BAR111 should be installed only after the Cyldro fixture is suspended in its final position.

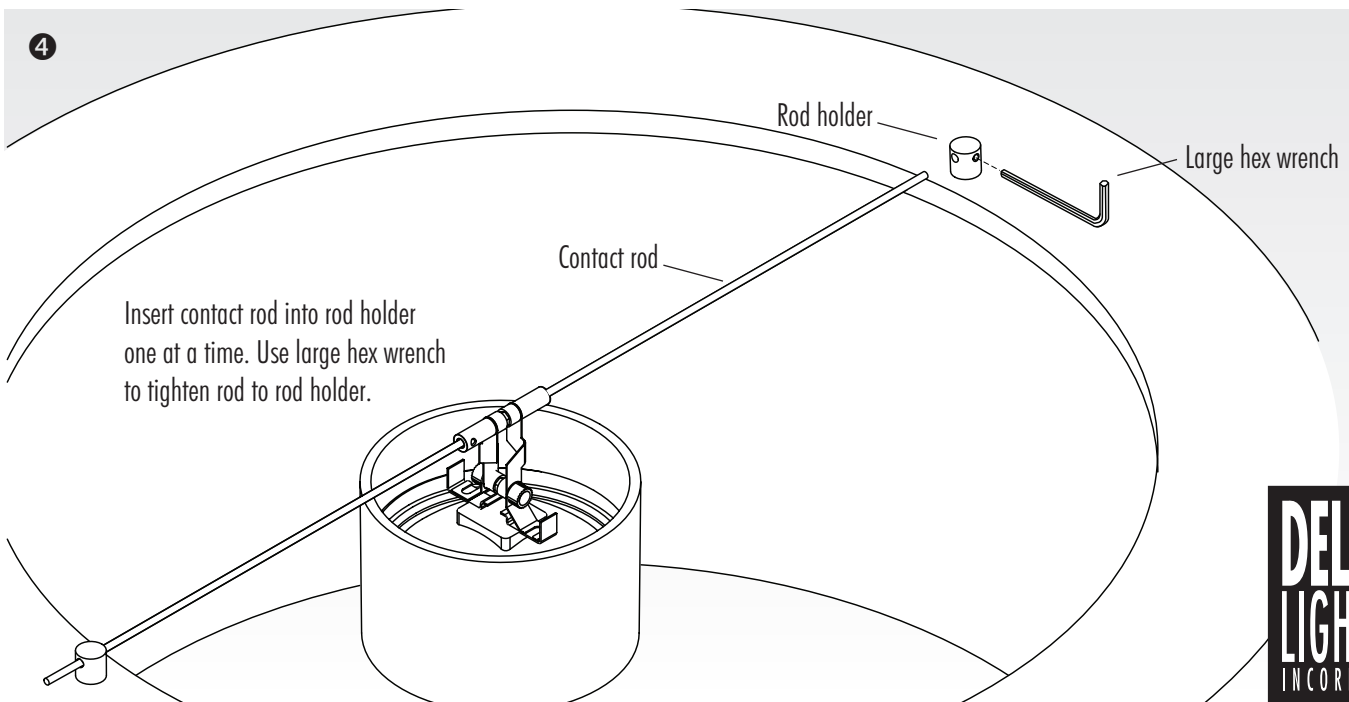

4
 Insert contact rod into rod holder one at a time. Use large hex wrench to tighten rod to rod holder.