

ASPECT

Wall Mount Installation Instructions 1

1 SINGLE ARM MOUNT

Mount 3" mud ring to J-Box.

Attach fixture arm to back plate with screws.

Attach arm and back plate to mud ring with flathead screws.

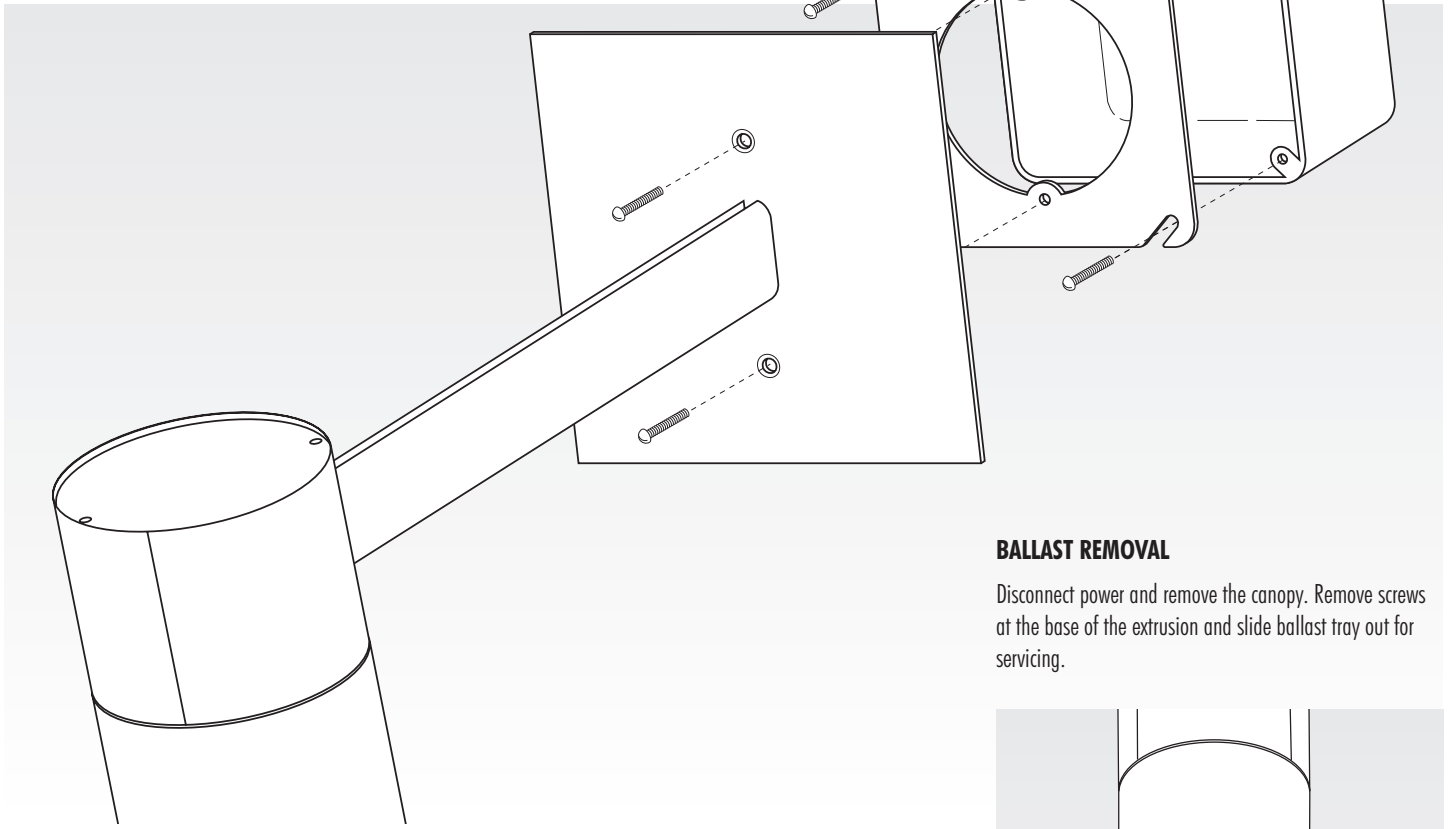

BALLAST REMOVAL

Disconnect power and remove the canopy. Remove screws at the base of the extrusion and slide ballast tray out for servicing.

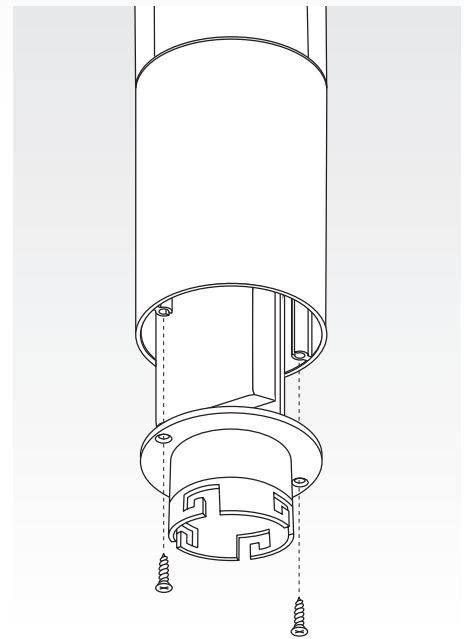

2 ATTACH SHADE

For fixtures with shades, slide the shade over the bolts, with the spacers beneath the shade, and secure with cap nuts.

Install with shade curved downward (as shown at right).

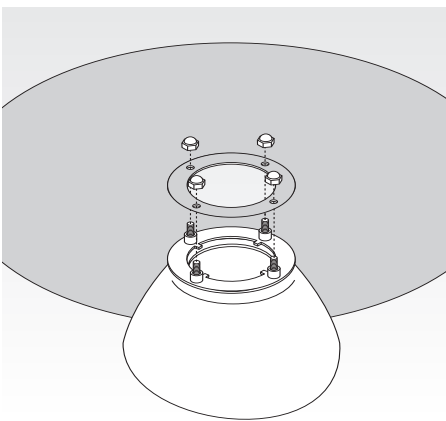
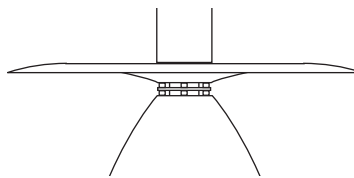

3 ATTACH LUMINAIRE

Attach socket holder by inserting the four reflector/glass assembly prongs into the slots on the socket holder and twist dropping into place.

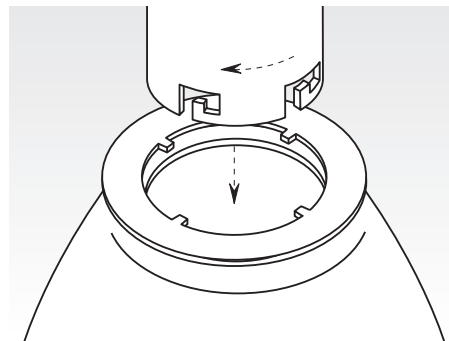

ASPECT

Wall Mount Installation Instructions 2

DOUBLE ROD MOUNT

Mount back plate to octagonal box.

Attach cover plate to back plate with flathead screws.

Attach ballast compartment to cover plate with Allen head screws.

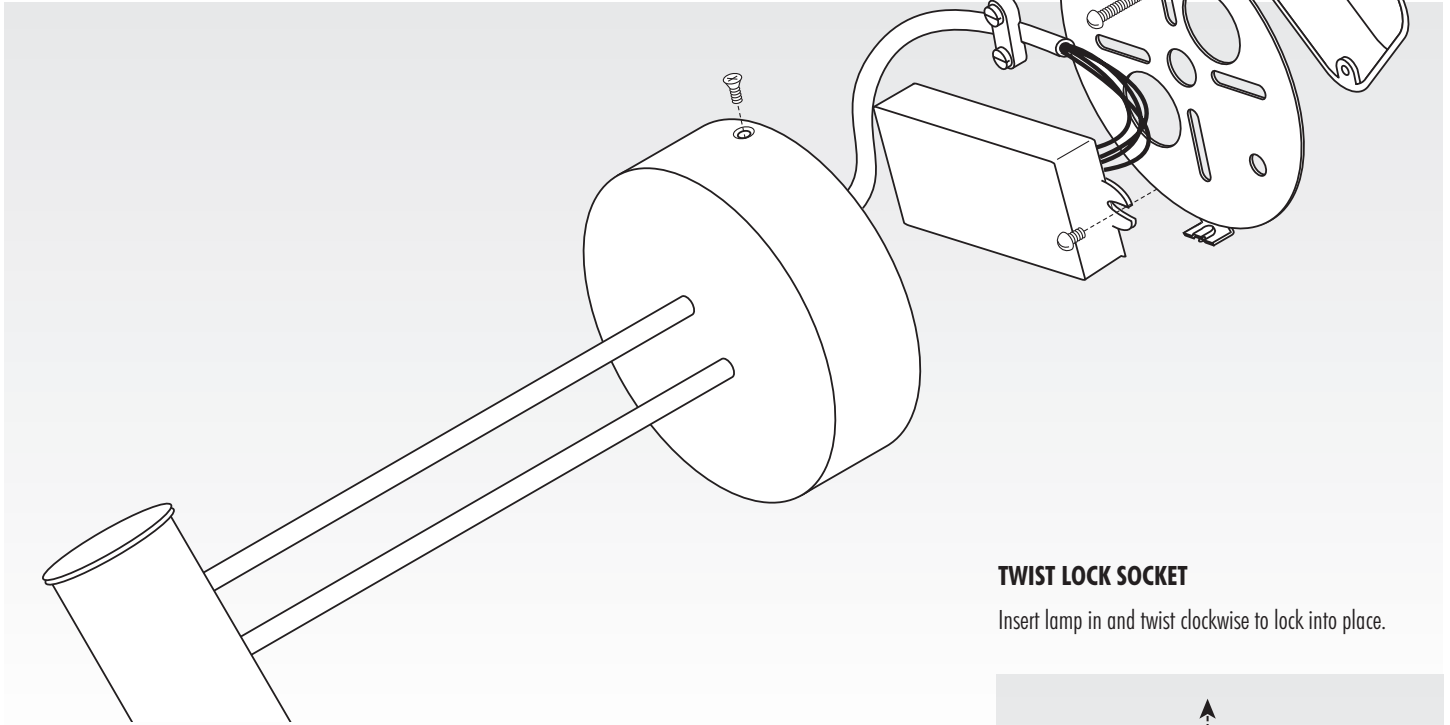

TWIST LOCK SOCKET

Insert lamp in and twist clockwise to lock into place.

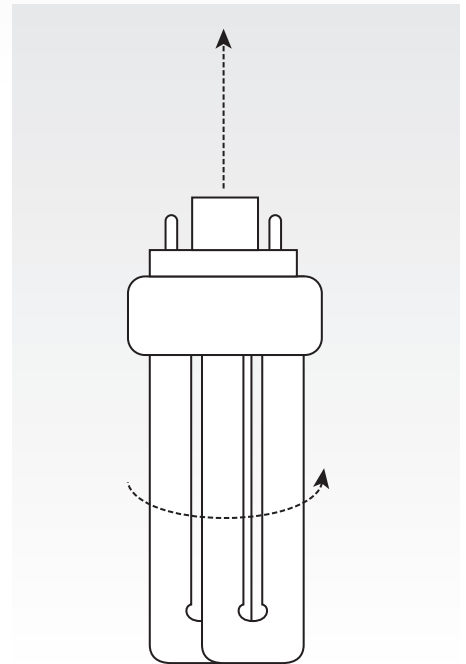

ARM EXTENSION INSTALLATION

Mount as shown below.

